

QWT229-L WR-229

Features:
* Low VSWR

Applications:
* Transmitters
* Antennas
* Laboratory Test
* Impedance Matching

Electrical

Frequency: 3.22~4.9GHz
VSWR: 1.03 max.

Mechanical

Waveguide Size: WR-229 (BJ40)
Flange: FDP40

Environmental

Temperature: -55~+125°C

Outline Drawings

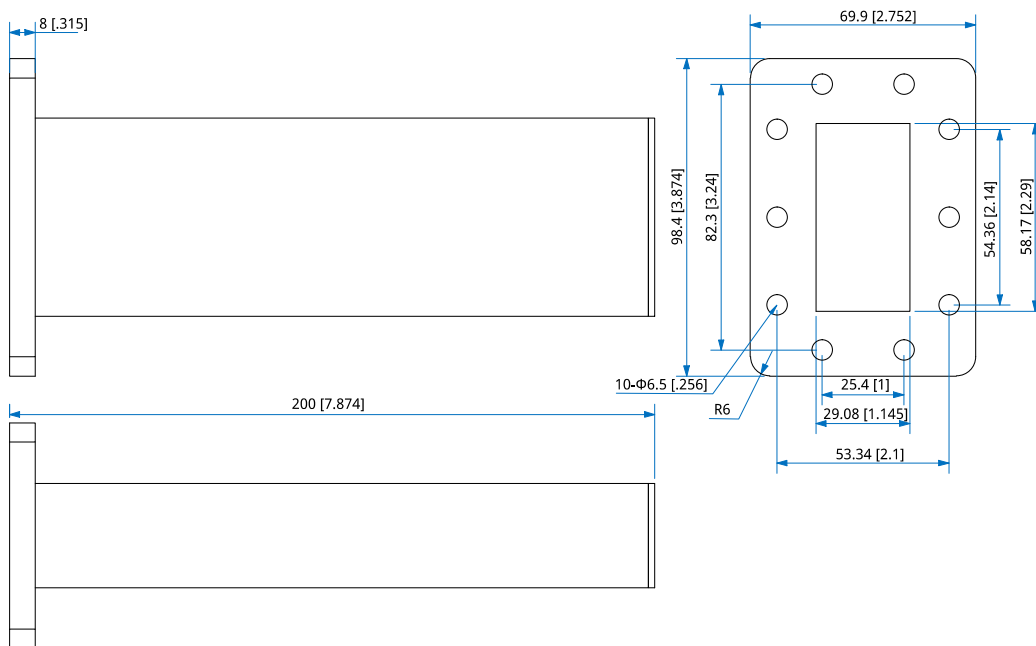

Outline A

Unit: mm [in]
Tolerance: ± 0.5 mm [± 0.02 in]

How To Order

QWT229-L-Y-Z

Y : Material

Z : Flange type

Material naming rules:
A - Aluminum (Outline A)

Flange naming rules:
2 - FDP40 (Outline A)

Examples:
To order a low power waveguide termination, WR-229, low power, Aluminum, FDP40, specify QWT229-L-A-2.

Customization is available upon request.